

ILLUSTRATED PARTS LIST

BOLENS 54 INCH CENTER MOUNTED ROTARY MOWER ATTACHMENT MODEL 18070-01

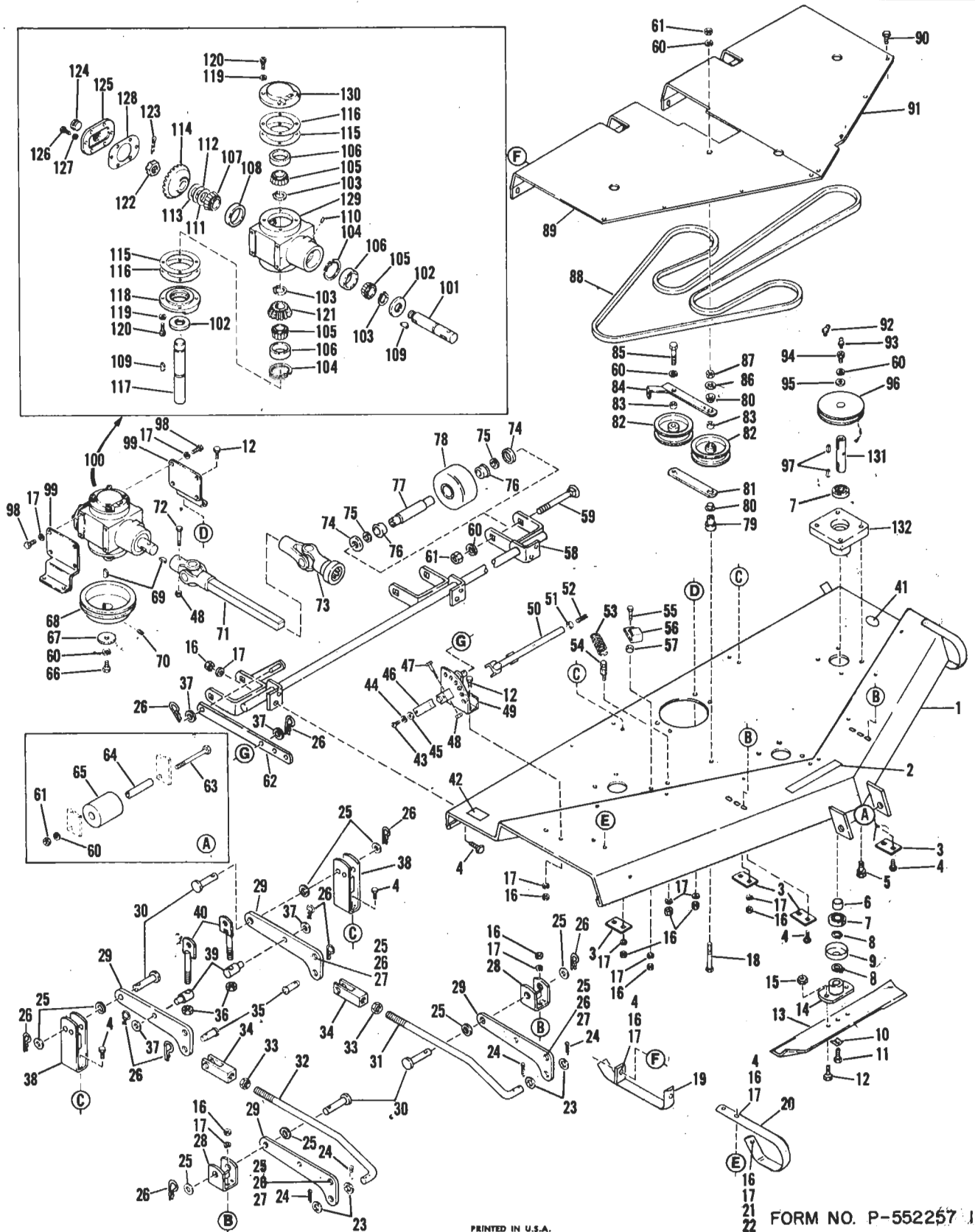

ROTARY MOWER MODEL 18070-01

Ref. No.	Part No.	Description	No. Req'd.	Ref. No.	Part No.	Description	No. Req'd.
1	1722 912	Base Assembly	1	67	1703 052	Flat Washer	1
2	1715 633	Decal - Bolens	1	68	1718 659	Sheave	1
3	1720 372	Support Plate	4	69	1100 276	Woodruff Key, 1/4x7/8	2
4	1106 876	Capscrew, 5/16-18x7/8	18	70	1103 466	Setscrew, 5/16-18x3/8	2
5	1185 670	Capscrew, 5/16-18x7/8 with lockwasher	12	*71	1722 632	Drive Assembly	1
6	1720 999	Spacer	3	72	1106 849	Capscrew, 1/4-20x1-3/4	1
7	1185 828	Ball Bearing	6	*73	1722 918	Universal Joint Assy	1
8	1185 708	Retaining Ring	6	74	1894 386	Cupped Washer	6
9	1716 744	Cap	3	75	1705 108	Flat Washer	6
10	1185 715	Lockwasher, 3/8 (Pyramidal Type)	3	76	1185 695	Ball Bearing	6
11	1100 009	Capscrew, 3/8-24x1	3	77	1717 737	Bearing Axle	3
12	1106 874	Capscrew, 5/16-18x3/4	12	78	1717 649	Roller	3
13	1722 883	Cutter Blade	3	79	1722 884	Idler Spacer	1
14	1722 882	Hub Assembly	3	80	1714 299	Nylon Bushing	2
15	1110 107	Locknut, 5/16 - 18	6	81	1718 649	Idler Arm	1
16	1182 563	Hex Nut, 5/16 - 18	27	82	1714 742	Idler Pulley	2
17	1100 242	Lockwasher, 5/16	35	83	1718 651	Spacer	2
18	1106 940	Capscrew, 3/8-16x3	1	84	1718 642	Idler Arm Assembly	1
19	1712 899	Rear Runner Assy	1	85	1107 249	Capscrew, 3/8-24x1-3/4	1
20	1722 896	Right Hand Runner	1	86	1100 265	Flat Washer	1
21	1106 878	Capscrew, 5/16-18x1	1	87	1121 551	Jam Nut, 3/8 - 16	1
22	1803 327	Flat Washer, 5/16	1	88	1718 653	V-Belt	1
23	1107 387	Flat Washer, 3/8	4	89	1722 903	Right Hand Belt Cover	1
24	1100 351	Cotter Pin, 1/8x1-1/4	4	90	1185 712	Self Thrd Screw, #10 - 20 x 1/2	17
25	1107 386	Flat Washer, 5/8	12	91	1722 902	Left Hand Belt Cover	1
26	1703 011	Spring Cotter	16	92	1110 086	Grease Fitting, 45°	1
27	1713 501	Clevis Pin	4	93	1104 954	Grease Fitting	1
28	1722 947	Lift Bracket Assy, Front	2	94	1719 331	Bolt	3
29	1722 726	Link	4	95	1708 755	Flat Washer	3
30	1708 040	Clevis Pin	4	96	1722 886	Pulley	3
31	1722 805	Left Hand Rod	1	97	1108 852	Sq. Key, 3/16 x 3/4	6
32	1722 806	Right Hand Rod	1	98	1106 872	Capscrew, 5/16-18x5/8	8
33	1121 513	Hex Nut, 5/8 - 11	2	99	1722 901	Support Bracket	2
34	1714 573	Rod End	2	100	1718 650	Gear Box Assembly	1
35	1719 324	Clevis Pin	2	101	1718 622	Input Shaft	1
36	1110 110	Locknut, 1/2 - 13	2	102	1185 687	Oil Seal	2
37	1107 385	Flat Washer, 1/2	6	103	1185 689	Retaining Ring	3
38	1722 720	Rear Lift Bracket Assy	2	104	1118 735	Retaining Ring	2
39	1715 401	Stud	2	105	1185 661	Bearing Cone	3
40	1715 404	Link Assembly	2	106	1185 660	Bearing Cup	3
41	1722 725	Decal - Caution	1	107	1185 688	Bearing Cone	1
42	1715 670	Decal - Caution	1	108	1185 118	Bearing Cup	1
43	1114 748	Mach Screw, #10-32x1/2	1	109	1709 611	Woodruff Key, 1/4 x 7/8	2
44	1100 240	Lockwasher, #10	1	110	1182 682	Breather	1
45	1103 959	Flat Washer, #10	1	111	1800 750	Shim, 1-1/2 x .003	1
46	1718 655	Spring	1	112	1800 751	Shim, 1-1/2 x .005	1
47	1106 847	Capscrew, 1/4-20x1-1/2	1	113	1800 338	Shim, .015	1
48	1110 106	Locknut, 1/4 - 20	2	114	1717 459	Gear, 29T	1
49	1718 667	Quadrant Assembly	1	115	1717 456	Gasket	10
50	1718 664	Handle Assembly	1	116	1719 501	Gasket	2
51	1719 328	Spacer	1	117	1718 621	Shaft, Output	1
52	1185 400	Roll Pin, 5/16 x 1-1/4	1	118	1717 454	Bearing Retainer	1
53	1706 822	Extension Spring	1	119	1100 242	Lockwasher, 5/16	8
54	1715 210	Spring Anchor Bolt	1	120	1185 686	Capscrew, 5/16-18 x3/4	8
55	1106 884	Capscrew, 5/16-18x1-1/2	1	121	1717 457	Bevel Pinion, 18T	1
56	1719 338	Belt Guide	1	122	1185 662	Slotted Nut, 7/8 - 14 UNF	1
57	1722 948	Spacer	1	123	1100 352	Cotter Pin, 1/8 x 1-1/2	1
58	1722 894	Wheel Yoke Assembly	1	124	1185 685	Plug, 3/4 - 14 NPT	1
59	1111 293	Carr. Bolt 3/8-16x4-1/2	3	125	1717 448	Cover	1
60	1100 243	Lockwasher, 3/8	10	126	1185 684	Capscrew, 1/4-20x5/8	6
61	1121 509	Hex Nut, 3/8 - 16	5	127	1100 241	Lockwasher, 1/4	6
62	1722 888	Lift Link	1	128	1717 449	Gasket Cover	1
63	1106 958	Capscrew, 3/8-16x6	1	129	1719 710	Gear Case (Incl. 107, 108 111, 112 and 113)	1
64	1720 578	Spacer	1	130	1718 620	Bearing Retainer	1
65	1720 577	Roller	1	131	1722 887	Drive Shaft	3
66	1111 708	Capscrew, 3/8-24x5/8	1	132	1722 865	Bearing Housing	3

*1714 207 Repair Kit for Joint Marked 6N

*1714 208 Repair Kit for Joint Marked NEAPCO PRINTED IN U.S.A.

FORM NO. P-552257 11-70