

# Model 492

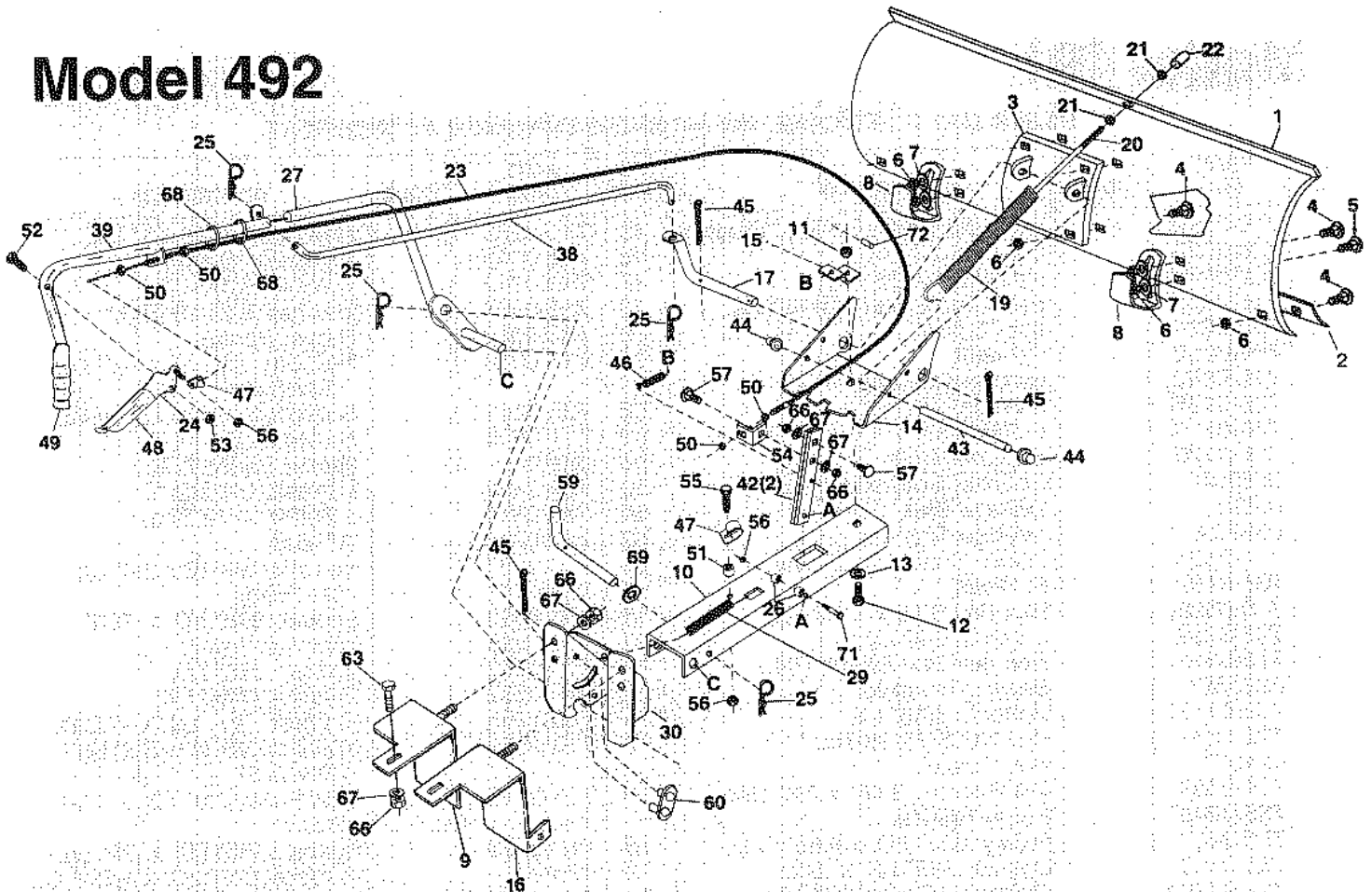

**PARTS LIST FOR MODEL 190-492 42" SNOW BLADE**

| REF. NO. | PART NO. | QTY. | DESCRIPTION                   | REF. NO. | PART NO.  | QTY. | DESCRIPTION                           |
|----------|----------|------|-------------------------------|----------|-----------|------|---------------------------------------|
| 1        | 23863    | 1    | Blade 42"                     | 38       | 46049     | 1    | Rod, Blade Pivot                      |
| 2        | 23117    | 1    | Wear Plate 42"                | 39       | 62972     | 1    | Ass'y. Lift Handle Tube               |
| 3        | 62980    | 1    | Reinforcement Plate Ass'y.    | 42       | 23151     | 2    | Angle Lock Bar                        |
| 4        | 43080    | 10   | Bolt, Carriage 5/16-18 x 3/4" | 43       | 23856     | 1    | Spring Mount Rod                      |
| 5        | 43079    | 2    | Bolt, Carriage 5/16-18 x 1"   | 44       | 44917     | 2    | Palnut, 3/8"                          |
| 6        | 43064    | 11   | Nut, Hex Lock 5/16-18         | 45       | 43010     | 3    | Cotter Pin 1/8" x 1-1/4"              |
| 7        | 43081    | 4    | Washer, 5/16"                 | 46       | 43348     | 1    | Angle Lock Spring                     |
| 8        | 23070    | 2    | Skid Shoe                     | 47       | 746-0260  | 2    | Cable End Fitting                     |
| 9        | 17511    | 1    | Support Bracket (L.H.)        | 48       | 731-0869  | 1    | Grip, Plastic                         |
| 10       | 62970    | 1    | Ass'y. Channel Sub            | 49       | 46198     | 1    | Handle, Grip 3/4"                     |
| 11       | 43262    | 1    | Nut, Hex Lock 1/2-13          | 50       | 712-0256  | 4    | Hex Jam Nut 5/16 Thread               |
| 12       | 23131    | 1    | Bolt, Special Pivot           | 51       | 23658     | 1    | Spacer                                |
| 13       | 43352    | 1    | Washer, Flat 7/16"            | 52       | 43085     | 1    | Hex Bolt, 5/16-18 x 1-1/2"            |
| 14       | 23958    | 1    | Plate, Pivot 7 Ga.            | 53       | 43064     | 1    | Hex Lock Nut 5/16-18 Thread           |
| 15       | 23130    | 1    | Bracket, Spring Mt.           | 54       | 05762     | 1    | Cable Mount Bracket                   |
| 16       | 17512    | 1    | Support Bracket (R.H.)        | 55       | 1509-90   | 1    | Hex Bolt 1/4-20 x 1-1/4"              |
| 17       | 46066    | 1    | Shaft Pivot                   | 56       | 43013     | 3    | Hex Lock Nut 1/4-20 Thread            |
| 18       | 43070    | 2    | Washer 3/8" Std.              | 57       | 710-0305  | 2    | Carriage Bolt 3/8-16 x 1-1/4"         |
| 19       | 9466R    | 1    | Spring, Blade Adjust          | 59       | 46065     | 1    | Pivot Channel Shaft                   |
| 20       | 44071    | 1    | Bolt, Hex 3/8-16 x 3-1/2"     | 60       | 63034     | 1    | Lift Link Ass'y.                      |
| 21       | 43015    | 2    | Nut, Hex 3/8-16               | 63       | 43001     | 4    | Hex Bolt 3/8-16 x 1"                  |
| 22       | 44074    | 1    | Plastic Cap                   | 66       | 43015     | 10   | Hex Nut 3/8-16 Thread                 |
| 23       | 746-0366 | 1    | Control Cable Ass'y.          | 67       | 43003     | 10   | Lock Washer 3/8"                      |
| 24       | 62561    | 1    | Release Grip Ass'y.           | 68       | 726-0178  | 2    | Plastic Tie                           |
| 25       | 43055    | 4    | Pin, Hairpin Small 3/32"      | 69       | R19171616 | 1    | Washer                                |
| 26       | 46053    | 2    | Spacer, .28 I.D. x 1"         | 71       | 46071     | 1    | Bolt, Hex 1/4-20 x 3-1/4" Lg. (Gr. 5) |
| 27       | 63033    | 1    | Lift Handle Rod Ass'y.        | 72       | 43349     | 1    | 1/4" x 1" Spring Pin                  |
| 29       | 732-0153 | 1    | Extension Spring              |          |           |      |                                       |
| 30       | 24023    | 1    | Pivot Support Bracket         |          |           |      |                                       |