

# Owner Manual with Parts List

**BOLENS**

**SNOW PLOW**

TYPE 21531-02

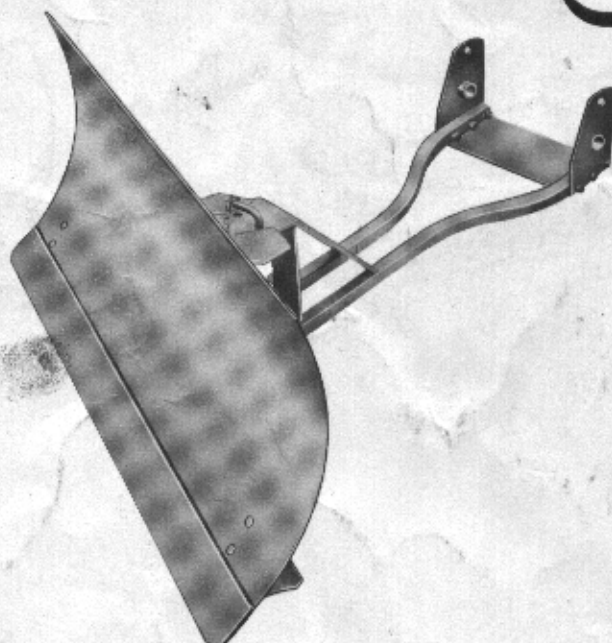

## DESCRIPTION

The 21531-02 Snow Plow is designed for use with all Ride-A-Matic tractors.

The unit is shipped as one bundle consisting of a front blade assembly, hitch assembly and an envelope of miscellaneous parts.

### INSTALLATION ON MODEL 220 TRACTOR

Remove the two capscrews from the upper and lower rear bracket extensions of the blade assembly. Set the blade assembly up on its shoes and position the hitch assembly (model plate upward) at the rear so the upper and lower holes align with capscrew holes in rear brackets of blade assembly. The upper bracket of the blade assembly will be between the lips of the top of hitch assembly. Replace capscrews but do not tighten nuts too tightly as blade must be allowed to swivel. Insert angle control pin.

Remove foot rests from tractor frame. Position upper holes of support brackets over shoulder bushings behind foot rests. Replace foot rests and secure in original position.

Place unit in front of tractor with hitch arms extending under front tractor axle and secure arms to inside of support brackets with capscrews provided.

Place cable lift bracket over pin welded to hitch and secure with cotter pin.

Attach clevis end of lift cable to tractor lift lever and secure with clevis pin and cotter pin. Run cable forward over guide pulley on right front of tractor frame and attach to cable clamp bolt. The cable length should be adjusted so the tractor lift lever is all the way back when the snow plow is raised against tractor frame. This will provide enough cable slack to allow the blade to ride freely on the ground when the tractor lift lever is forward.

The shoes are designed with slotted capscrew holes so they can be raised or lowered to adjust the height of blade.

### INSTALLATION ON MODEL 200 AND 21HD TRACTOR

The installation to these tractors is identical to installation on model 220 tractor except for the position of the two support brackets.

Remove capscrew and end washer from both ends of tractor foot rest.

Slip the center hole of support brackets (shoulder inward) over each end of tractor foot rest. Move support brackets parts pre-drilled holes in foot rest and secure with clevis pins and spring clips. Secure hitch arms to inside of support brackets with capscrews provided. Complete installation of lift cable according to regular instructions.



**BOLENS PRODUCTS DIVISION**

Food Machinery & Chemical Corporation

Port Washington

Wisconsin

PARTS LIST

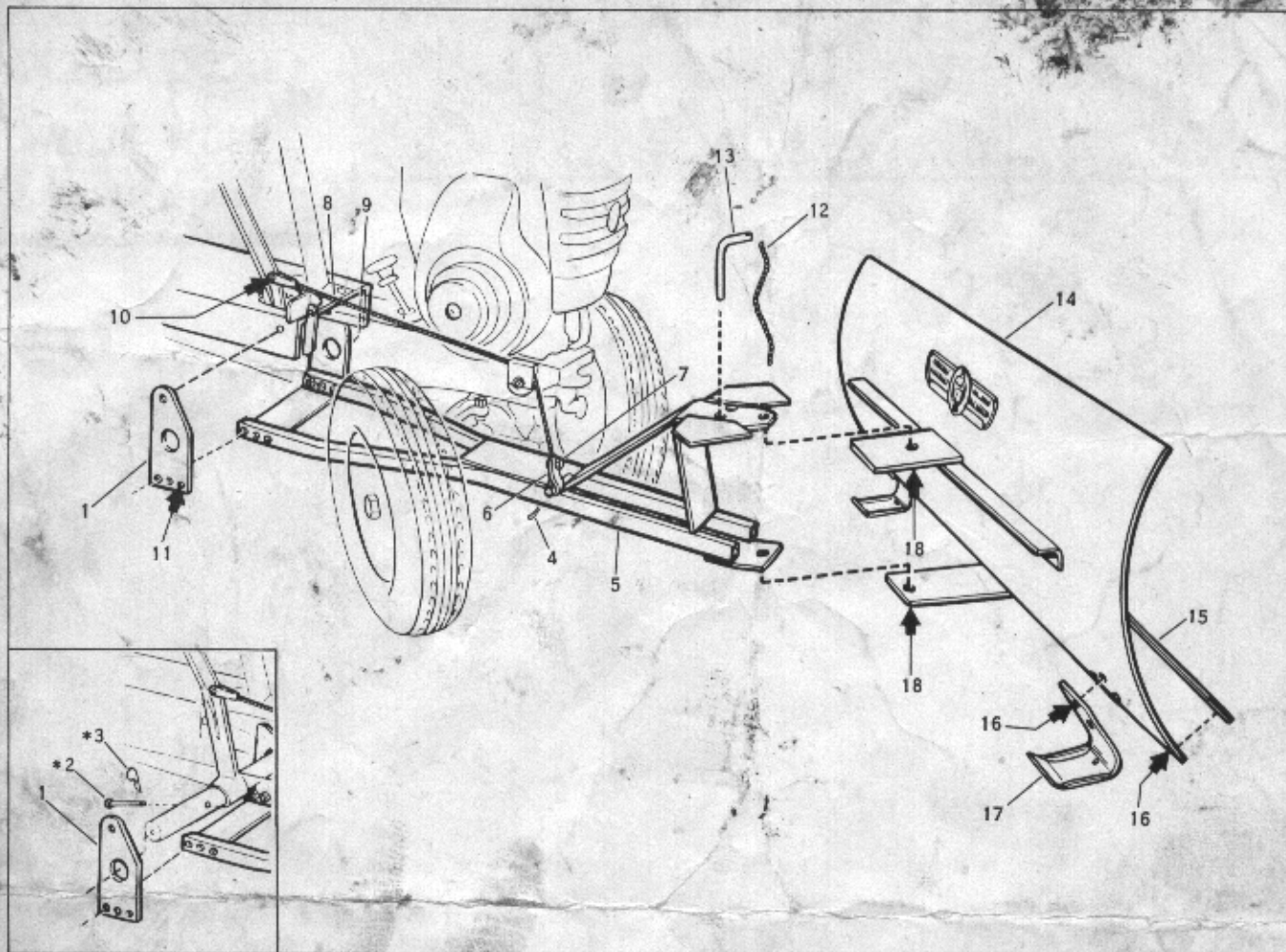

Ref. No.	Part No.	Description	No. Req'd.
1	1708066	Support Bracket RH	1
*2	1182614	Clevis Pin	2
*3	1703011	Spring Clip	2
4	1100349	Spring Clip	1
5	1705643	Frame	1
6	1706032	Lift Bracket	1
7	1700066	Cable Clamp Bolt	1
8	1705650	Cable	1
9	1708096	Support Bracket LH	1
10	1703697	Clevis Pin	1
11		Capscrew, 3/8-16 x 1-3/4"	4
	1706121	Hitch Assy. (Incl. items 1 thru 11)	
12	180173	Chain	1
13	310814	Pin	1
14	990576	Blade	1
15	1700379	Scraper Blade	1
16		Carriage Bolt, 5/16-18 x 3/4"	10
17	308812	Shoe	2
18		Capscrew, 1/2-13 x 1-1/4"	2
	1110096	Self Locking Nut	2
	1705663	Blade Assy. (Incl. items 12 thru 18)	

\*Used Only with Model 200 and 21 HD Tractors